

**F E A T U R E S**

SCE Spin-A-Veyer® valves are a compact and economical electro-proportional control valve designed specifically for spreader applications. They are compatible with most electronic spreader controllers and provide independent control of both the auger, spinner, and liquid output flows. The SCE Spin-A-Veyer® can be used alone or within a central hydraulic system. With a high flow inlet, and optional cartridge valve flows, it can easily adapt to light, medium, and heavy duty spreader applications.

**Pressures to 3,500 PSI**

- Capable of operating the most demanding spreader applications

**Pressure Compensated Flows to 22 GPM**

- Accommodates most popular spreaders, including tailgate and V-box

**Unparalleled Meterability**

- Operator achieves precise and repeatable material distribution

**High Flow Relief**

- Can serve as main relief in central hydraulic system

**Adaptable to Gear Pump or Load-Sensing Systems**

- Accommodates open or closed center circuits

**Integrated Power Beyond**

- Provides spreader priority when plumbed before main control valve (when applicable)

**Hardened Cartridge Bores and Spools**

- Increased service life and greater resistance to contaminants

**Manual Override Standard**

- A must for troubleshooting and emergency backup

**Easy to Service and Repair**

- Cartridge style elements are serviceable within minutes

**Optional Weather Resistant Enclosure**

- Gasketless design that stops harmful salt spray while venting damaging moisture

**Manufactured by FORCE America's Valve Manufacturing Division**

- The recognized leader in quality and cost effective solutions



Available with two or three valve spools.

## Installation Information

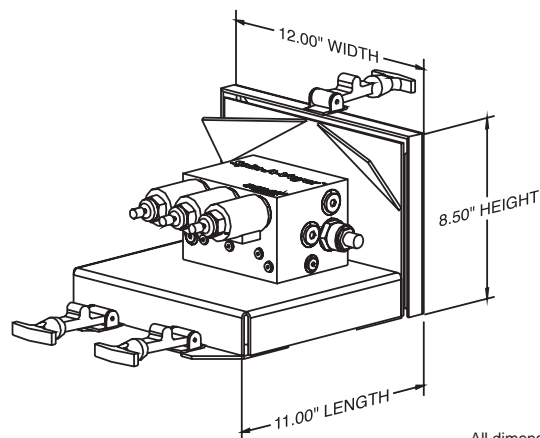

All dimensions are approximate

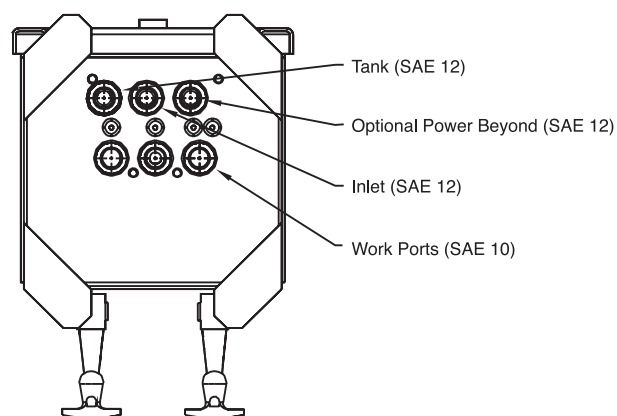

## Specifications

### Valve

Nominal Flow Rating.....35 gpm  
 Operating Pressure (maximum).....3500 psi  
 Temperature Range.....-20° F to +180° F  
 Fluid Requirements.....petroleum  
 Filtration Requirements.....ISO 4406 18/14100%  
 Seals.....BUNA-N  
 Mounting Sensitivity.....none

### Electrical

Rated Voltage.....12 VDC  
 Coil Resistance (at 68°).....4.7 ohms  
 Current.....1.5 amps  
 Power.....18 Watts  
 Duty Cycle.....100%  
 Frequency.....100-400 Hz PWM  
 Standard Electrical Connector.....Weatherpack®  
 Optional Electrical Connector.....DIN

## Product Specifications

Series	# of Sections	Inlet	1	2	3	Relief	Connector
<b>SCE</b>							
<b>CODE</b>		<b>CODE</b>		<b>CODE</b>	<b>Flow</b>	<b>CODE</b>	<b>Type</b>
SCE		UL Unloader LS Load Sense		07 7 gpm 14 14 gpm		D DIN Omit Weatherpack®	
	<b>CODE</b>	<b># of Sections</b>	<b>CODE</b>	<b>Flow</b>		<b>CODE</b>	<b>Adjustable Relief</b>
	2 2 Section 3 3 Section		07 7 gpm 14 14 gpm 22 22 gpm		AR Set at 2000 psi		

1-888-99-FORCE

501 East Cliff Road Burnsville, Minnesota 55337 [www.forceamerica.com](http://www.forceamerica.com)

### Sales and Service Centers

© 2019 FORCE America, Inc.  
 FA510-1119-02

Bismarck, ND 800-624-7568	Denver, CO 888-833-7711	Minneapolis, MN 800-328-2732
Charlotte, NC 800-788-8598	Fort Dodge, IA 800-362-2994	Philadelphia, PA 800-492-6621
Chicago, IL 800-433-5765	Kansas City, MO 800-383-4724	Salt Lake City, UT 877-230-0505
Columbus, OH 888-449-0356	Memphis, TN 888-845-5876	
Dallas, TX 800-893-7225	Milwaukee, WI 800-722-5844	

Atlanta, GA (Atlanta Powertrain™)	888-293-2325	<a href="http://atlantapowertrain.com">atlantapowertrain.com</a>
Seattle, WA (Mobile Equipment Systems™)	800-354-9028	<a href="http://mobileequip.com">mobileequip.com</a>